

Wulian[®]

Corporation passed the ISO9001:2008 international
quality control system certification.

Wireless Automatic Window Operator

Model:WL-ZMCDN-W-01

User Manual

Welcome to Use the User Manual Of Wireless Automatic Window Operator

- **Wulian**, are the trademarks and registered trademarks of Nanjing IOT Sensor Technology Co., Ltd. The other products mentioned in this article or company names may be the trademark or trade name of their respective owners.
- Before installing and using the products, please read user manual carefully, which will help you use the products better.
- Wulian wireless automatic window operator (for short "this product") is made by Nanjing IOT Sensor Technology Co., Ltd (for short "our company") .This product should be used together with app and its accessories. Our company will not take any responsibility for the damage caused by the wrong install and use.
- We may update the information for this manual without inform. Please pay attention to our company, download the newest app.
- The content in the manual is protected by copyright law legislator. It strictly prohibits any forms of copying, passing, distributing and storing any content of the manual without prior, written, consent of the instructor of Nanjing IOT Sensor Technology Co., Ltd.
- Welcome to visit us: www.wulian.cc. to know more about smart home.

Product Features

- Support new generation Protocol of IEEE 802.15.4.
- Realize the scene and linkage by coordinating with curtain controller.

Products list

| Products list | | |
|---------------|--|-----|
| NO. | Description | QTY |
| a | Automatic window operator | 1 |
| b | Mounting bracket(R.L) | 2 |
| c | Hex head screw of Mounting bracket | 2 |
| d | Fixed frame of chain | 1 |
| e | Pin fixation of chain | 1 |
| f | Round nut | 1 |
| g | Head tapping screws ($\phi 5$,provide for yourself) | 10 |

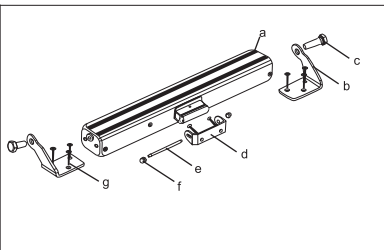

Specification parameter

| Specification parameter | unit | Technical data |
|-------------------------|--------|----------------|
| Thrust/Force | N | 400 |
| Maximum working current | A | 0.4 |
| Progress distance | mm | 50~800 |
| Drive speed | Mm/sec | ~10 |
| Working voltage | V | AC220V±10% |
| Ambient temperature | ℃ | -20~+75 |
| Protection level | IP | 32 |

- It can be used in upper, middle, lower hanging window, outside type window, inside type window, flat window, scuttle, etc.
- There are a variety of brackets to meet the different needs of the installation.
- Customized in progress, push pull, surface color by different requirements.
- Window operator has built-in electronic device, it can control by using microcomputer chip (MCU), with the function overload protection against obstruction.

Installation instruction

① Wiring diagram

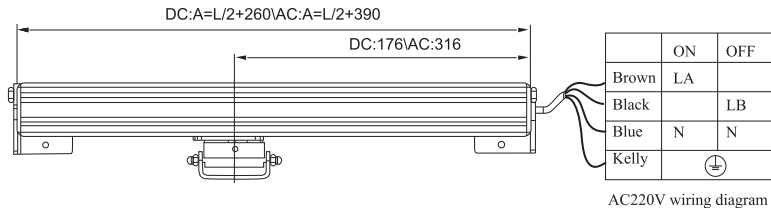

② Installation steps

- Determine the center line of the window open door, as shown in Figure 1.
- Keep the center line of the window open door and the mounting bracket of the chain coincide with each other, and keep the direction of the longer hole in the mounting bracket and the chain inside, meanwhile, make the chain to operate the windows closed, then use two of the $\Phi 5*25$ mm pan head tapping screws to fix, as shown in Figure 2.
- To determine the position of a chain's fixed frame according to the location of the mounting bracket, keep the chain and fenestration vertical, each bracket is fixed with three of the $\Phi 5*25$ mm pan head tapping screws, as shown in Figure 3.
- Put the window operator between the two middle bracket, and use a hexagonal screw to fix for each end; then put the front end of the chain block into the middle of the fixed frame, insert the fixed frame, and install the nuts on both ends, such as figure 4.

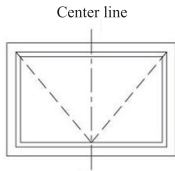

Figure 1

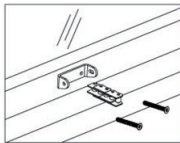

Figure2

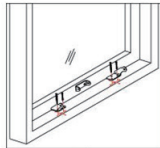

Figure3

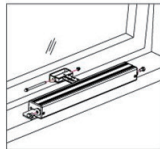
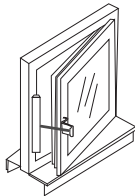
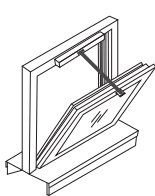
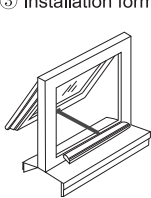
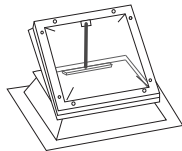

Figure4

③ Installation forms



5



Note for installation

- Running a round trip before the installation to make sure the operator can be safe operation;
- Before installing the window operator, check whether the opening progress of window is greater than the opening progress of window operator And test whether the window opening and closing is normal;
- When installing the fixed frame of the chain, the direction of longer hole should be consistent with the inside of the chain;
- The chain and the window frame can not contact, to keep a distance of more than 3 mm;
- Cut down the power of the window operator before make the operator work, to prevent electric shock risk;
- When the window operator is running, don't put the hand between window frame and window door, to prevent the danger of clipping the hands;
- The installation and connection must go through the professional training persons, the installation persons must be familiar with the technology parameters and installation standards of the smart window control system.

Note for use and maintenance

- When this product is installed, the installation personnel should be operated according to the national safety standards, to ensure the operation safety;
- Do not directly install this product can be in the rain to outdoor;
- This product has no hand prevention function , so be careful when installing;
- Be sure the window is safe when install/ unload the window operator ,to avoid the accident;
- The platform or ladder should be supported for the installers when the operator will be installed above 2.5 meter to the ground;
- If the operator has functional failure and damage, please contact the dealer or customer service, do not use the operator without repair;
- Regularly check every year whether the power cord for window operator is broke, and the situation of the brackets are firm etc..

Order information

| | |
|---------------|---|
| Description | Wireless Automatic Window Operator_DN_W |
| Product Model | WL-ZMCDN-W-01 |
| Cargo No. | WLPN1202875 |

Zip code: 210039

Service Hotline: 400-889-2891

Website: www.wulian.cc

Building 11, No.15, Fengji Road, Yuhuatai District, Nanjing